

Way to realise all your dreams....

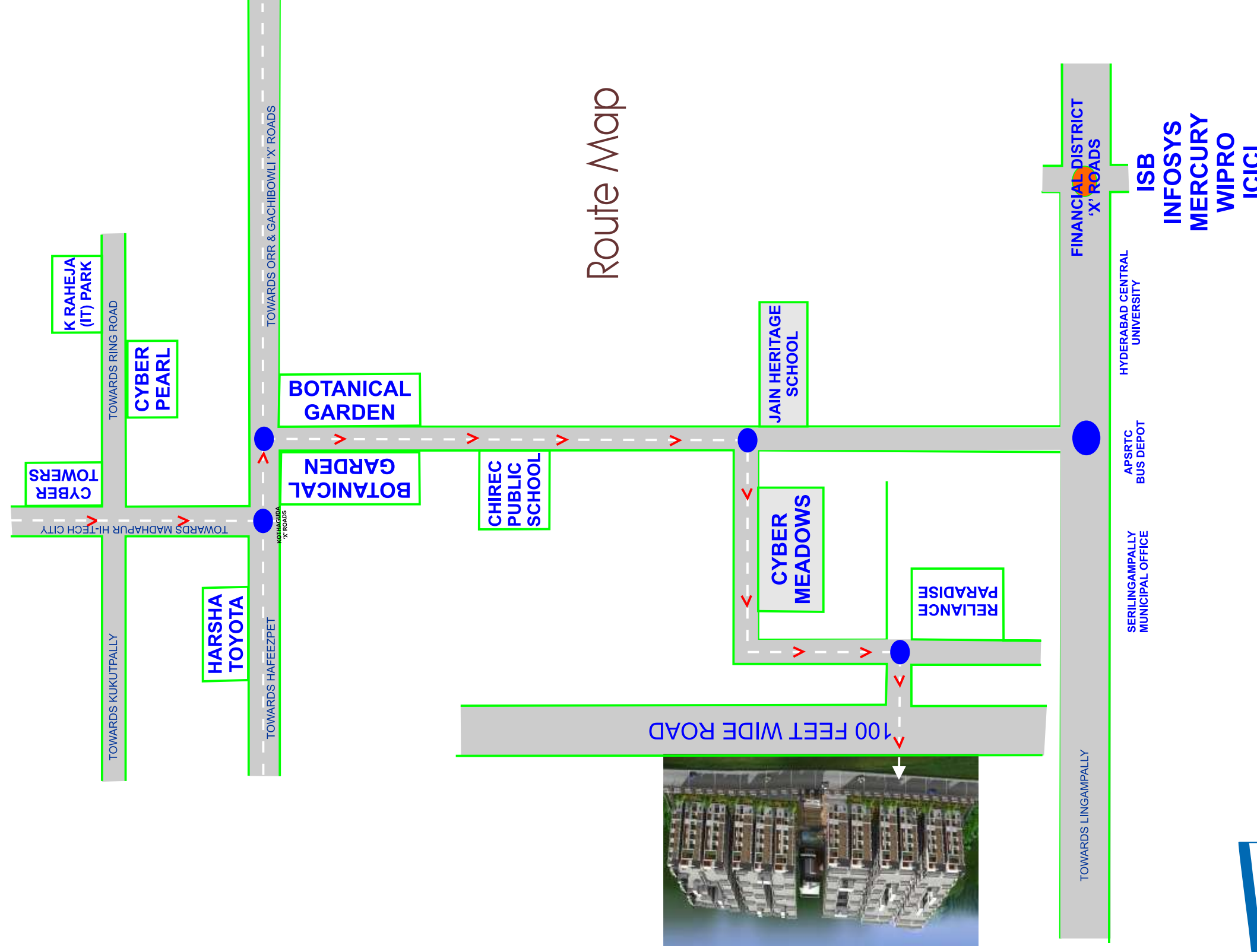

Project developed by -

Trishala Infrastructure Pvt. Ltd.
 (a subsidiary of Namishree Infrastructures Pvt. Ltd.)
 THE GRAND (Near Hotel PARK)
 3rd Floor, 0-3-1090/B/4,
 Raj Bhavan Road, Somajiguda,
 Hyderabad.
 Tel: +91-40-6553 7217, 2322 7534
 email: trishalainfra7@gmail.com
 Website: www.trishalainfra.com



an opportunity to tune your emotions
to pleasures of life!



Own a
home
that let
your
dreams
come true!

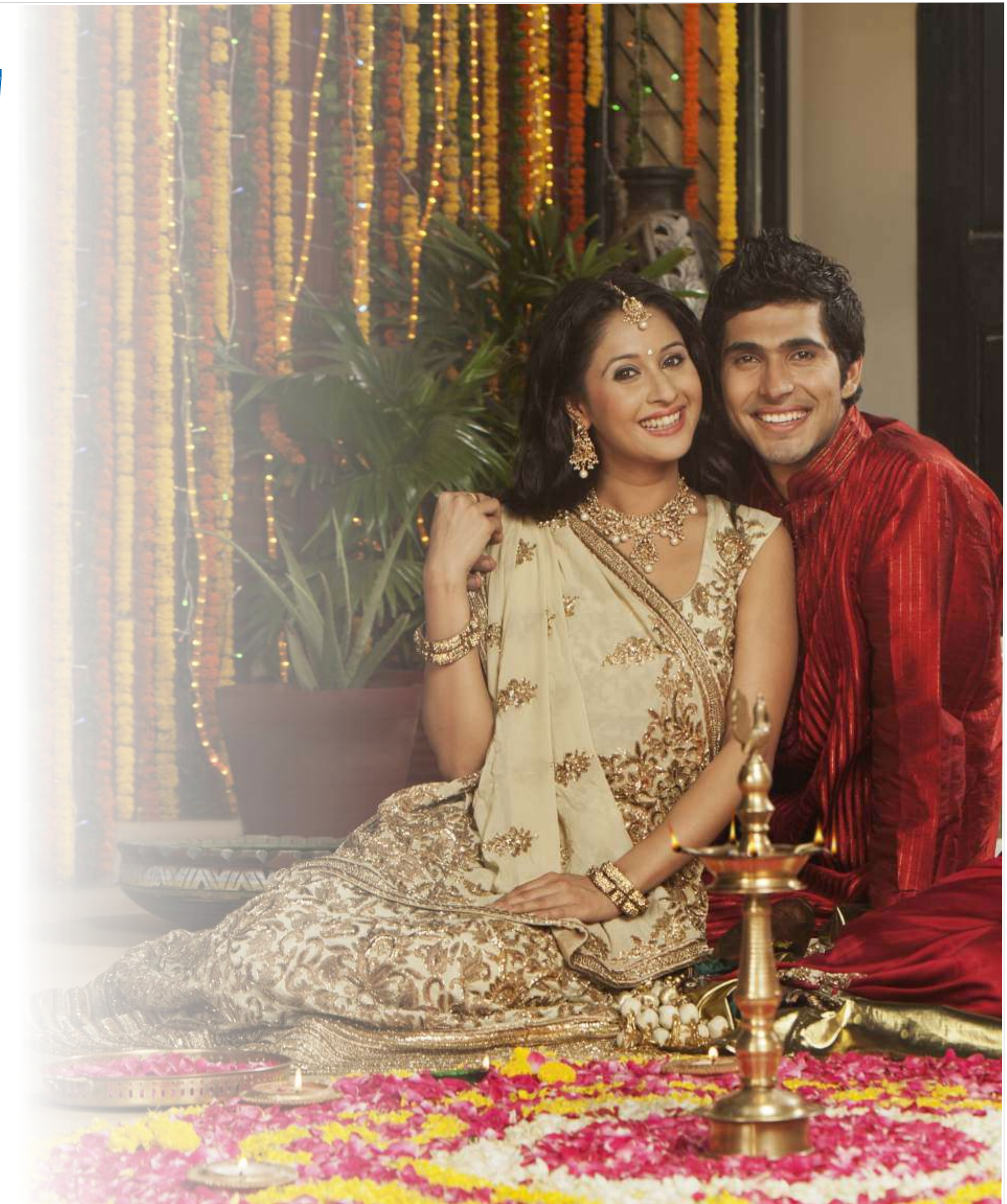

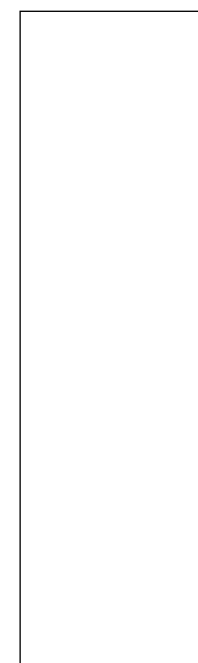

...Values that are always a part of your dreams



an ambience which
favors peace & happiness
in every moment !

Luxor apartments is a lovely residential hub, ideally located at the vibrant part of the city.

You live your life to maintain your own happiness while trying to maintain a perfect balance between your needs and resources.

We at Luxor apartments nurture your unique needs and give you what you deserve the most for you to enjoy a peaceful and happy living. We understand your needs - both emotional and financial. Owning a home at Luxor apartments helps surround yourself with happy people, apart from the feeling of a proud owner of a home, that you call it YOURS.

If you ever wanted to know what it means to be happy and what it takes to achieve happiness and peace, book your future home at Luxor apartments, NOW.



...a lifestyle that is always part of your dreams



an investment which
is as secured as the
loving care of a mother !



...expectations that are always part of your dreams



an address that
gifts you an unique
position & identity !



an initiative that
reaps the benefits of
growth and prosperity !



...a vision that is always part of your dreams



...aspirations that are always part of your dreams



*Own your dream home and
make every dream a cherished dream !*

Foundation & Structure	:	RCC framed structure Ready mix concrete for slabs
Super Structure	:	Outer wall are of 9" & inner walls are of 4 ½" thick lightweight fly ash brick, with cement motar (1:6 prop) / if light weight cement blocks are used then outer walls shall be 6" thick and all internal walls are shall be 4" thick.
Cupboards	:	One loft of 2' width shall be provided in each bedroom subject to availability of space
Doors & Shutters	:	Main door shutter and door frames are of teak wood. All internal door shutters shall be made of designer flush doors. All internal door frames are of teakwood.
Windows	:	UPVC windows shall be of NCL/Fenesta/AAIfa/Imported Window grills of Iron Decorative
Hardware	:	Locks shall be of Godrej/Dorset/Europa or equivalent makes for main doors & SS fittings.
Kitchen	:	Platform will be provided with granite along with wall cladding up to 2' ft above platform with Johnson/Somany/Kajaria/Imported tiles. Provision for exhaust fan – Provision for RO system, Provision for Hob & Chimney Loft shall be provided as per availability of space Nirali/Imported Kitchen Sinks
Toilets	:	All toilets shall be of non- slippery ceramic tile flooring with Johnson/Somany/Kajaria/Imported tiles. Wall cladding with ceramic tiles up to 7' height. All CP Fittings of marc / jaguar / equivalent . All sanitary fittings of Hindware/Cera/imported Make. Water proofing with proper sealants Provision for geysers in all toilets Pedestal wash basin in all toilets PP-R/CPVC pipes to be used. Ashirwad / astral / imported Make
Flooring	:	Vitrified tiles of Johnson / imported or equivalent – 605*605 or 800*800.
Staircase & corridors	:	Aesthetically designed Marble or Granite or combination of both.
Lift wall cladding	:	Aesthetically designed granite cladding or any natural stone as per design
Painting	:	Internal wall are of smooth finish (lappam Birla White Putty) Paints with plastic emulsion paint (Asian make) External walls are with 2 coats of cement plaster in textured finish as per design Outside with 2 coats of weather coat paint (Asian) Main door shall be neatly polished.
Electrical & Communication	:	Concealed Copper wiring of Finolex /Ploy cab/ Havell's. Modular Switches of Legrand, North-west, Gold Medal or Havell's. Geyser power points in all bath rooms Three phase supply with all circuits breakers (MCBS) – Legrand make T.V. Point (1 Bedroom & hall) - A.C. Points in all bed rooms. Telephone points in master bedroom and sitting / dining area 4Pair TP cable – 2 points. Internet/Broadband – 1 Point. Adequate power points in the kitchen

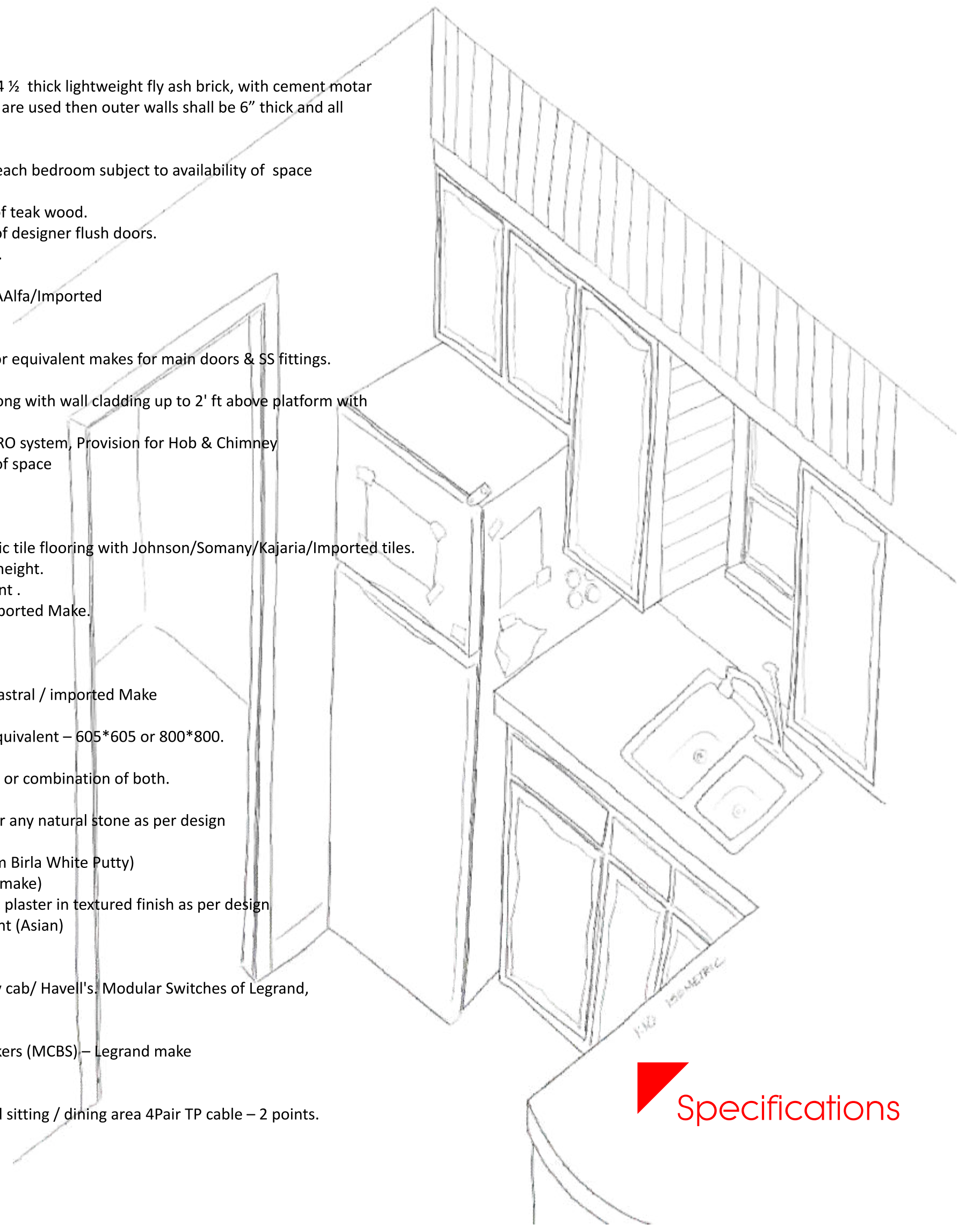

 Specifications

- All units designed as per vastu
- All units are totally independent (No Common Walls)
- Modern Club House
- Community Hall
- Swimming Pool
- Landscape Garden Area
- Children's Play Area
- Dedicated Transformer
- Provision for Super Market
- Furnished Gymnasium
- Provision for Play School for kids
- Provision for wash Rooms for Drivers
- 3Phase 5 KW Electricity Meter
- Provision for Yoga and Meditation Hall
- Adequate Power Backup for common area
- Provision for Spa and Beauty Parlour

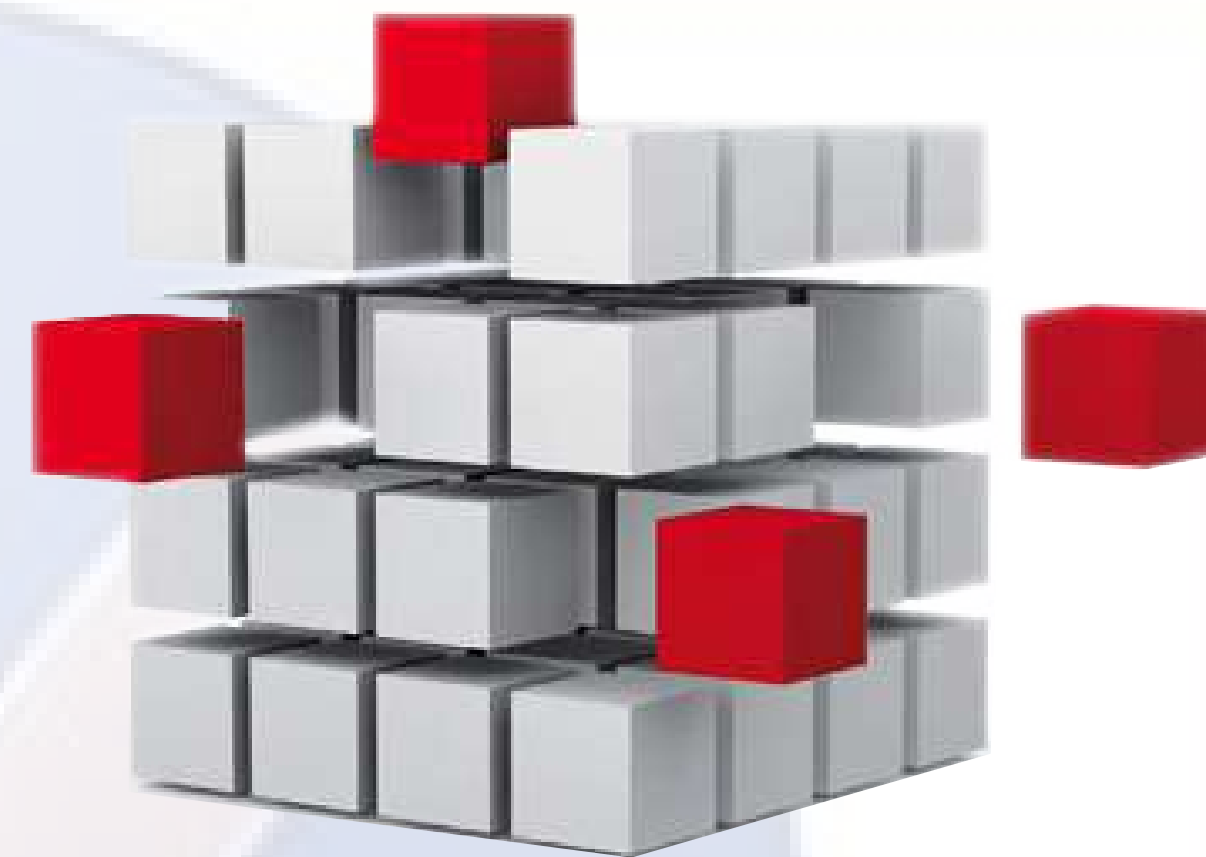

Nearby you can find different shops, restaurants, educational institutions apart from a host of highly reputed national and multi national corporate.

Metro stations are at easy distance from Luxor apartments apart from easy drive way to the international airport, making everything that matters accessible, very easily.



Layout
Block Plan



an assurance that you
will feel the satisfaction of
living in a self made home!

assurance

...an assurance that is always part of your dreams

